

MANGUSTA MAXI OPEN 92#26 – CLAUDIA'S

CAREFULLY USED YACHT



BUILDER: OVERMARINE GROUP

YEAR: 2009
ASKING PRICE: EURO 2,450,000

VAT: PAID
FLAG: MALTA

PORT OF REGISTRY: VALLETTA
LOCATED: FRANCE

TYPE OF YACHT

Twin water-jet diesel Mediterranean Sport Motor Yacht of contemporary design, in the style of the other Mangusta motor yachts, with a modified deep V planning hull, flared bow and transom type stern with integrated bathing platform.

HULL

Hull structure: Advanced GRP single skin composite structure based on Vinyl-ester Resin. Hand lay-up process.

Deck and Superstructure: Advanced GRP sandwich composite structure based on Vinylester Resin. Hand lay-up and infusion process.

CLASSIFICATION

Built to Bureau Veritas Class / For commercial : built in compliance with MCA – MGN 280 – Cat 2 up to 60NM from safe haven

DIMENSIONS

LENGHT OVERALL	28.27 M	92.10 ft
LENGHT ON WATERLINE	23.50 M	77.1 ft
BEAM	6,6 M	21.65 ft
MAX DRAFT	1,50 M	4,9 ft
DISPLACEMENT AT FULL LOAD	~ 80 T	176,000 LBS
GROSS TONNAGE	~ 95 T	

TANK CAPACITY

FUEL CAPACITY	~ 8,800 L	2,325 US GALS
WATER CAPACITY	~ 1,400 L	369 US GALS
GREY & BLACK WATER	~ 300 L	79 US GALS

PROPULSION

MAIN ENGINES POWER	2 X MTU 16V 2000 M93 2400 HP EACH
HOURS	PORT 1450 – STBD 1450
STABILIZERS	Installation of a Seakeeper SK18 possible
TRANSMISSION	2 X KAMEWA 56 S3
GENERATORS	2 x KOHLER 27EFOZ 27 kw, 230VAC, 50Hz, single-phase
GENERATOR HOURS	~ 5442

PERFORMANCE

MAX SPEED HALF LOAD	~ 33 KNOTS
CRUISING SPEED HALF LOAD	~ 28 KNOTS
RANGE AT CRUISING SPEED	~ 300 NAUTICAL MILES

ACCOMMODATION

GUEST CABINS	1 OWNER'S SUITE + 1 VIP DOUBLE + 1 DOUBLE GUEST + 1 TWIN GUEST (with additional PULLMAN), all en-suite
CREW CABINS	2 TWIN CABINS FOR UP TO 4 CREW

PROFIL I

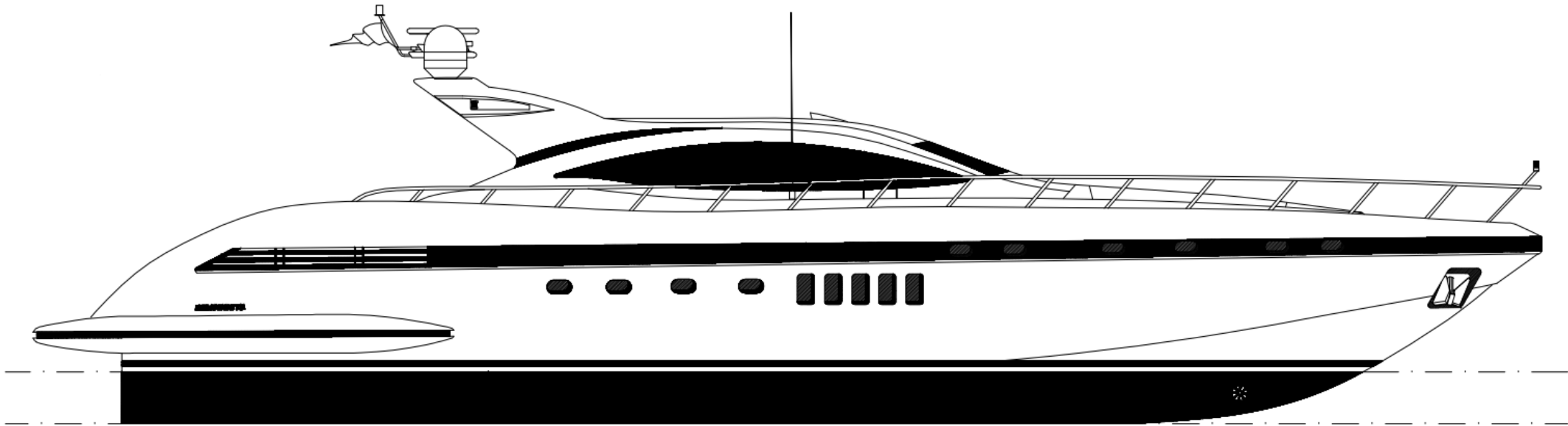

MAIN DECK

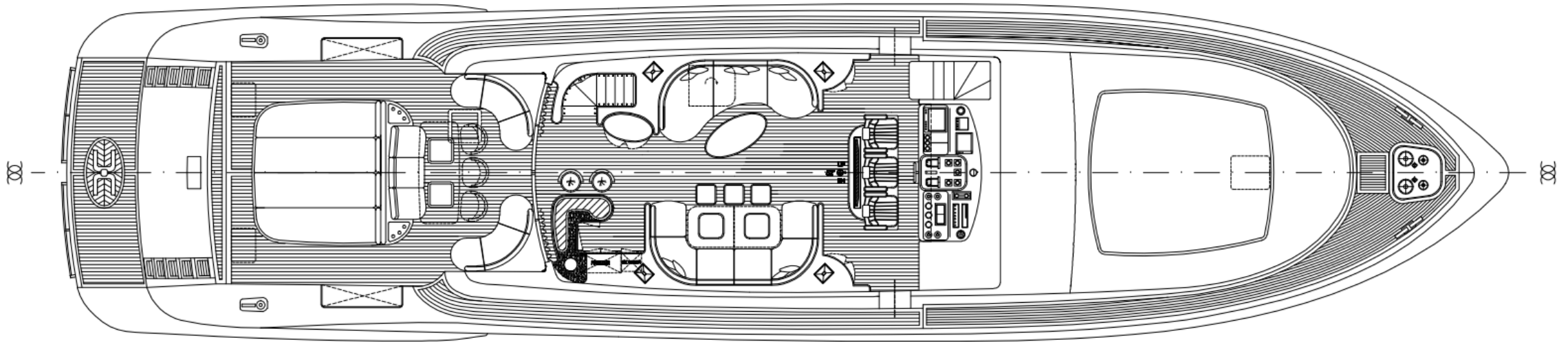

LOWER DECK

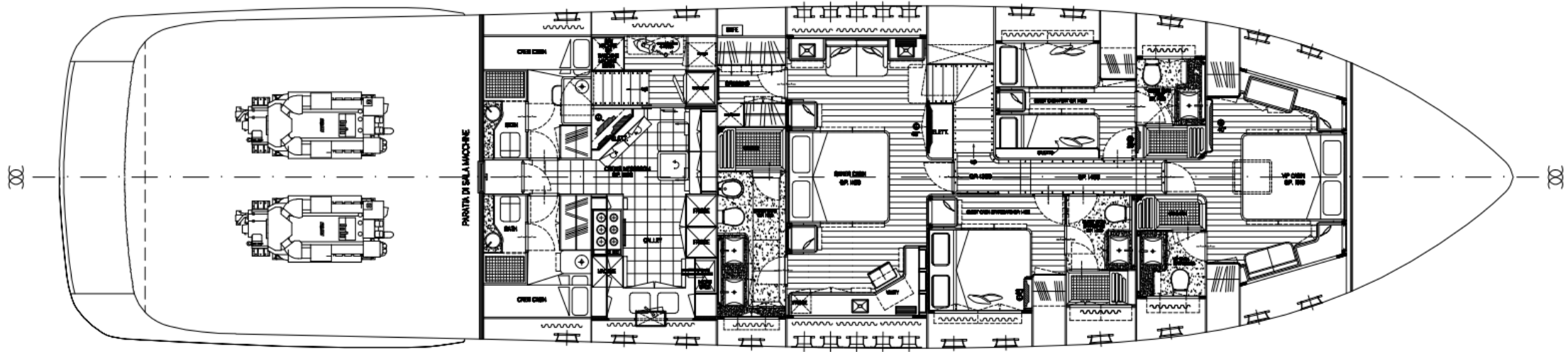

PROPULSION

Water Jets

WATERJET

Two waterjets Kamewa (RRAB) model 63 S3 connected to the output flange of the gearbox by means of a coupling supplied by Kamewa

GEARBOXES

Two flange-mounted reduction gears ZF model 3060

STEERING SYSTEM

Kamewa WJ steering system

DIESEL GENERATOR

2 x KOHLER 27EFOZ 27 kw, 230VAC, 50Hz, single-phase

GENERATOR HOURS(21/09/2023) : 5442hours

BOW THRUSTER SYSTEM

Hydraulic Bow Thruster 27 kW

ONBOARD SYSTEMS

FUEL SYSTEM

Fuel filtration system NFV - 2000L/H and clean fuel suction of the engines and generators after cleaning

2 x RACOR fuel filtration filters

BILGE/FIRE-FIGHTING SYSTEM

- Gianneschi bilge pumps and fire fighting

COMPRESSED AIR SYSTEM

- Frig-IT 230 V air conditioning with 3 compressors

DECK EQUIPMENT

WINCHES, ANCHORS AND CAPSTANS

Two Lofrans Project T 2000 – 2,5kW / 24V vertical anchor windlasses, with warping drum, installed in the foredeck, each complete with chain rollers and chain stopper.

ANCHORS AND CHAINS

- 2 Sec Shhp 105 kg galvanized anchors
- 2 X 14mm chain length of 100 meter galvanized

CAPSTANS

Two Lofrans T1500 - 1.5 kW/24V

GANGWAY

Sanguineti hydraulic gangway 4699 PASMANN 92 – 5.4 metres – max load 480 kg

SAFETY EQUIPMENT

ACCORDING TO CLASS REQUIREMENT

TENDER & TOYS

- Williams Turbojet 385
- Jet ski Yamaha FZ1350
- Seabob

NAVIGATION SYSTEMS & CCT

- Simrad vhf Dsc Rs82
- Simrad Ais AI50
- Zenitel Intercom Pro221/Aa704
- Simrad autopilot Ap50
- Simrad chart/plotter Gb65
- Simrad radar RB717 scanner 4ft
- Hatteland display 1 X 17" 2 X 15"
- Simrad Eb-pc B45/St650 depth-speed transducer
- Simrad gps CP31
- Furuno Navtex NX700B
- Simrad data repeater 3 X IS15
- Simrad compass RGC50 / Repeater AR78
- Airmar wind transducer
- Cctv with X3 cameras in the aft deck + 2 cameras in the engine room

COMMUNICATION EQUIPMENT

- Kvh Sat Com Tracphone F33
- Simrad VHF HS35
- Kvh satellite TV G8

HOUSEHOLD APPLIANCES

GALLEY & LAUNDRY ROOM

- 1 x Gaggenau oven
- 1 x Gaggenau induction hob
- 1 x Gaggenau extractor
- 1 x Gaggenau microwave
- 4 x FRIGIT refrigerators & freezers in Galley and bar fridges in Deck
- 1 x Wine fridge custom
- 1 x Brema CB 184 Icemakers in Galley
- 1 x MIELE dishwasher, G7856
- 1 x MIELE washing machines, PW 6065
- 1 x MIELE dryers, PT 7136

ENTERTAINMENT EQUIPMENT

- Domotic on board with Ipad controller in every areas : Control4
- Denon sound management system
- Salon Deck: LG TV 8K, Apple TV, Canal Sat, Loudspeakers with Multifunction mode
- Master Cabin: Sony Tv 40" with Apple TV, Loudspeakers with Multifunction mode
- Vip Cabin: Sony TV 20" with Apple TV, Loudspeakers with Multifunction mode
- Port Guest Cabin: Sony Tv 20" with Apple TV, Loudspeakers with Multifunction mode
- Stb Guest Cabin: Sony Tv 20" with Apple TV, Loudspeakers with Multifunction mode

EXCLUSIONS

A complete list of exclusions is available upon request.

REMARKS

Custom-built as his third Mangusta for her very experienced current owner, Claudia's has only ever been used privately and meticulously maintained by full-time professional crew. She is hull #26 out of 28 built in Mangusta 92 series and as such she is one of the most modern examples currently on the market which shows in her attractive contemporary interior design. She is offered in excellent overall condition and VAT paid.

RECENT SERVICE HISTORY

WINTER 2022/2023

- Fresh water tank cleaning
- MTU engines full services
- KOHLER generators full services
- All seawater intake valves replaced - Certified 3.1 commercial
- Full overhaul of KAMEWA actuators
- Full service of A/C and compressors
- Full service of cold systems (fridges/freezer)
- Antifouling and all regular yearly maintenance
- Jet-ski and Williams services and stored on land

WINTER 2021/2022

- Fuel tank deep cleaning and service
- Upgrade AV/AT and new salon TV
- New Kamewa touch screen control
- MTU engines full services
- KOHLER generators full services
- Jet-ski and Williams services and stored on land

NAVIGATION

























INTERIORS
MAIN DECK SALON







LOWER DECK
OWNER SUITE











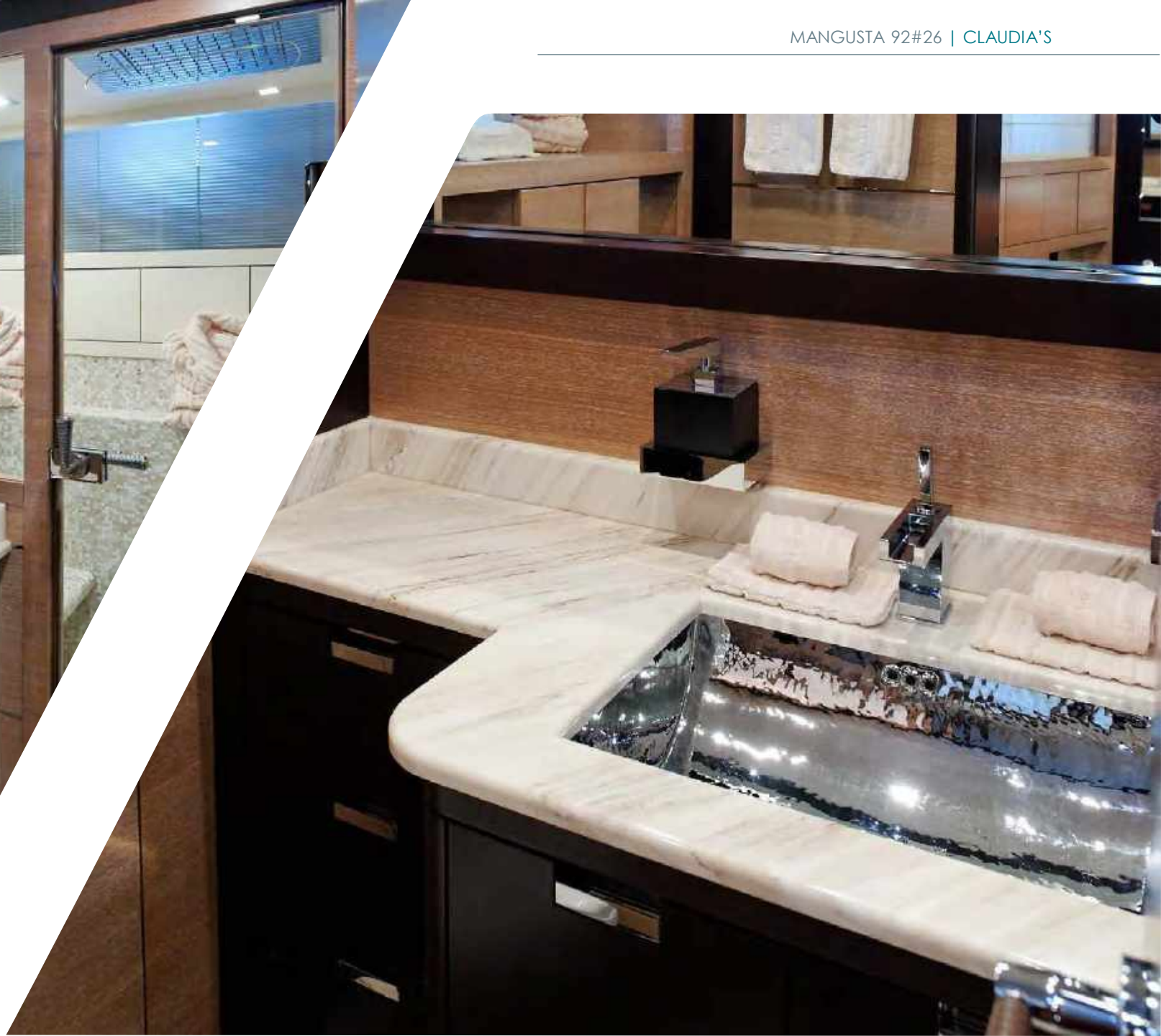

LOWER DECK
CREW AREA



Kindly note that broker friendly brochures may be used for private customer presentations only, not for publication on any websites.

DISCLAIMER:

The content of this brochure is for general information/promotional purposes only and does not constitute advice and/or in any circumstance whatsoever offer by Overmarine Group S.p.A. to any person. Overmarine Group S.p.A. do not represent or warrant that the information and/or specifications contained in this brochure are accurate, complete or current and specifically stipulate that certain yachts details and specifications contained in this brochure may differ in available models. Therefore, Overmarine shall never be considered liable in any way whatsoever for claims relating to or arising from any use made of any such information contained in this brochure. Technical and performance data, technical layouts, images and graphic reproductions, etc. shall be binding for Overmarine Group S.p.A. only to the extent that they are contractually stipulated and agreed. All intellectual property rights arising in this brochure belong to Overmarine Group S.p.A. and they cannot be used, copied, adapted, published, divulged or otherwise used without Overmarine Group S.p.A. prior approval.



COMMERCIAL OFFICES

1 M I A

PORT CAMILLE RAYON, 06220
GOLFE JUAN - FRANCE

PH. +33 (0) 6 85 99 91 21

FRANCE@MANGUSTAYACHTS.COM

A M E R I C A S

1201 20TH STREET SUITE CU-6, 33139
MIAMI BEACH -USA

PH. +1 786 440 3434

AMERICAS@MANGUSTAYACHTS.COM

BROKERAGE@MANGUSTAYACHTS.COM

mangustayachts.com/brokerage