



NEOPRENE

Length: 32.92 metres (108')

Beam: 7.57 metres (24' 10")

Draft: 1.2 metres (4')

Number of Guests: 10

Number of Crew: 5

Built: 2002

Refit: 2020

Builder: Mangusta (Overmarine)

Naval Architect: Stefano Righini

Flag: Cayman Islands

Hull Construction: GRP

Hull Configuration: Planing hull

Air conditioning, WiFi connection on board

NEOPRENE'S exceptional performance has been enhanced by a full engineering overhaul in 2017. With a top speed of 32 knots this 108 foot (32.9 m) motor yacht has a cruise speed of 28 knots.

Designed by Barth, Italy, NEOPRENE'S stunning matte-black exterior finish is matched by her lavish contemporary interior - a quality finish including silk carpets.

The open main deck provides more than ample space for 'life alfresco'. The main salon is perfect for dinner parties or maybe

just to unwind after a day on or in the water. On the foredeck sun worshippers can spend afternoons in a yachting paradise with canopies providing shade when required. The tender garage on NEOPRENE offers all one could wish for, for a beach club experience.

NEOPRENE'S lavish staterooms, (all en suite) accommodate ten guests. The master stateroom has a king-size bed and walk-in wardrobe. The other staterooms include a forward VIP with a double-bed, a double-bed stateroom and a quadruple stateroom with four bunks. In addition NEOPRENE also has accommodation for five crew members in three cabins.

NEOPRENE provides a truly unique yachting experience.

VIRTUAL TOUR: <https://my.matterport.com/show/?m=2LcSUXm3AXe&brand=0> (Copy link to browser)

VIDEO: https://youtu.be/THpLmv_LwBo (Copy link to browser)

KEY FEATURES

- 1** Light refit in 2020 with new teak decks, new toys, enhanced sound and audio
- 2** Fresh and modern interior
- 3** Great deck space for sunbathing
- 4** Striking matte black exterior finish
- 5** Extensive refit completed 2017
- 6** Sleek modern design
- 7** Impressive performance with a top speed of 32 knots
- 8** Stylishly appointed interior



Main Salon





Toys



Scorpion Tender



Toys



Main Salon



Master



VIP Cabin





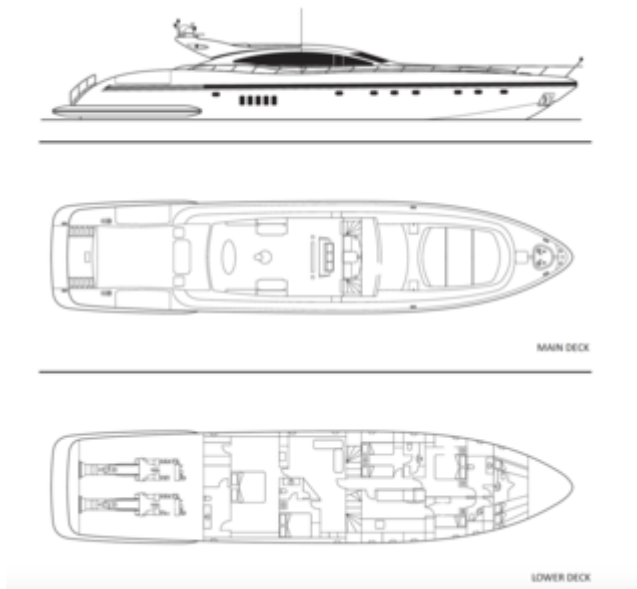

Double Cabin



Bunk Room



SPECIFICATIONS

ACCOMMODATION

Number of Guests: 10

Number of Cabins: 4

Cabin Configuration: 3 Double, 1 Twin

Bed Configuration: 1 King, 1 Queen, 1 Double, 4 Single

EQUIPMENT

Engines: 2 x MTU12V 4000 M90 (2735 HP)

2x Kohler Generators 33EFOZ, PA - 19729, / 380 VAC - 50Hz

More fuel consumption figures from Captain

24:25 knots is around 500 lt per hour

Cruising Speed: 22 knots

Fuel Consumption: 25kts calm sea state (less 1/2m)
circa 500lt per hour Litres/Hr

WATERSPORTS

Tenders + Toys: 10m Scorpion Silurian Chase Tender (RIB) with twin 300hp engines

3x SeaBobs

2x Paddle Boards

2x solid single seater kayaks

2x solid SUP

1x single inflatable kayak

Snorkels and fins

Inflatable Aft Dock

LAYOUT

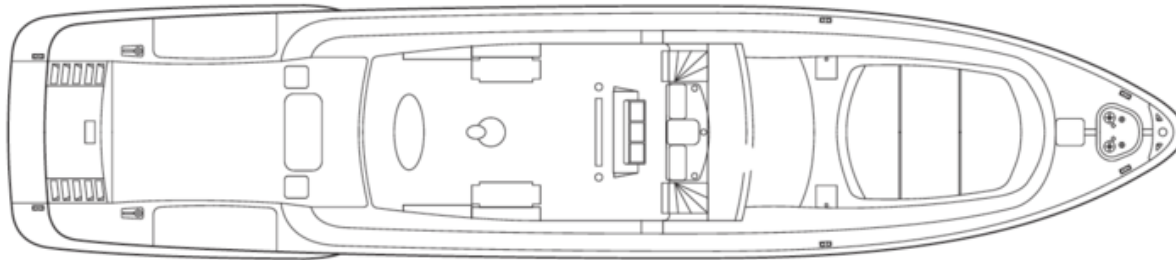
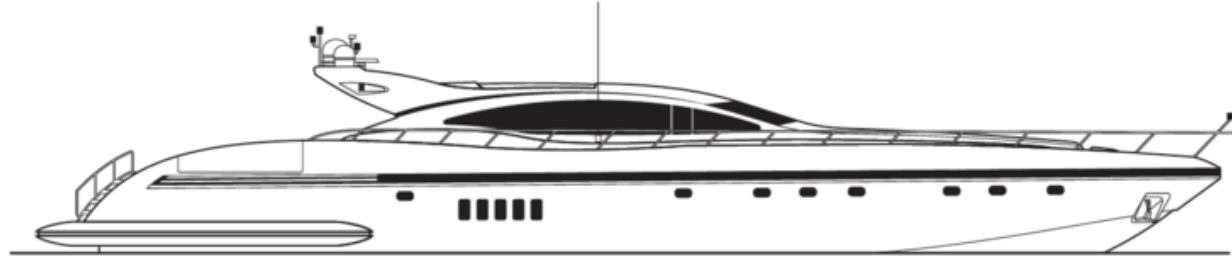

MAIN DECK

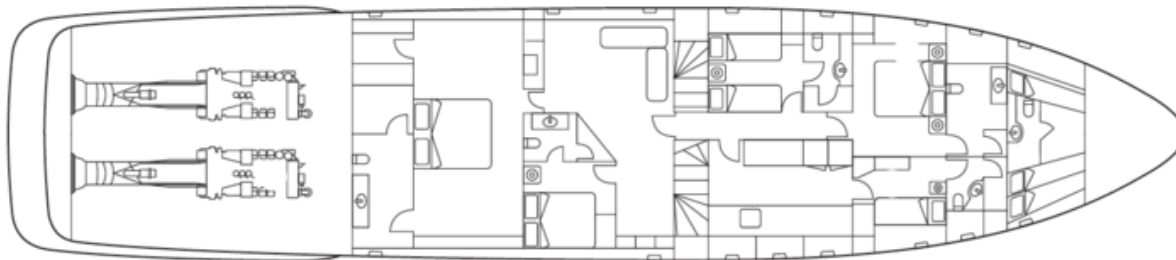

LOWER DECK

Disclaimer

This document is not contractual. All specifications are given in good faith and offered for informational purposes only. The publisher and company do not warrant or assume any legal liability or responsibility for the accuracy, completeness, or usefulness of any information and/or images displayed. Yacht inventory, specifications and charter prices are subject to change without prior notice. None of the text and/or images used in this brochure may be reproduced without written consent from the publisher.