



Sunseeker 88 Yacht - 5032288

£ 6,313,694 Ex Tax

Boat Details

Make Sunseeker	Model 88 Yacht	Model Year 2022	Location UK	Max Speed* 28 knots
--------------------------	--------------------------	---------------------------	-----------------------	-------------------------------

Engines

Make MTU	Model 12V 2000 M96L	Engine HP 1950	Drive Type Shaft Drive	Range 400 Nm
--------------------	-------------------------------	--------------------------	----------------------------------	------------------------

Dimensions

LOA 26.3m/86.29ft	Draft 1.95m/6.4ft	Beam 6.47m/21.23ft	Weight 67000kg/67t
-----------------------------	-----------------------------	------------------------------	------------------------------

Tankage

Fuel Capacity 11000l	Water Capacity 1400l	Black Water Capacity 435l
--------------------------------	--------------------------------	-------------------------------------

Accommodation

Cabins 4	Guests 8 Berth(s)	Heads 5	Crew Cabins 2	Crew 4 Berth(s)
--------------------	-----------------------------	-------------------	-------------------------	---------------------------

*Performance details are intended as a guide only and are not binding and do not constitute part of any terms and conditions.



Description

Combining a superyacht feel with all the practical advantages of a yacht in this size category.

The 88 Yacht has impressive, and new to the brand, exterior lines and a sleek hardtop roof.

This yacht will stand out in any marina around the world. Powered by twin MTU 12V 2000's as standard, she accommodates eight guests and four crew in complete luxury and comfort and is capable of reaching speeds of up to 28 knots.

The 88 Yacht features Sunseeker's industry-leading 'Beach Club' concept which is accessed by dual teak staircases featuring recessed LED lighting. The 'Beach Club' transforms the area into a private outdoor sanctuary complete with innovative X-TEND™ sunbed that converts under an optional parasol. Beneath, is an overhead rain shower and plentiful stowage including dedicated lockers for two Seabobs with charging points. This is the perfect yacht for relaxing, entertaining and having fun in style.

Accommodation

The main deck is nothing short of spectacular. Inside, there is a large forward galley helping to maximize the open-plan entertaining space. It gives owners and crew an amazing amount of practical storage space, as well as a dedicated fixed breakfast bar unit with two stools, creating an additional informal dining space.

The galley has a full height premium fridge freezer and dishwasher. There is also the ability to fully close off the galley, allowing crew to move around the yacht unnoticed with access from the lower helm on the starboard side that gives the owners the chance to enjoy complete privacy.

The interior has a real feeling of opulence and clever design cues throughout that really make the yacht stand out, including diagonal stainless detailing on cabinetry and doors. The layering of textural elements and the mix of furnishings and fabrics feels timeless with a modern twist that oozes style and elegance.

This 88 Yacht has a 4 Cabin Layout for 8 guests, comprised of a spacious Master cabin, VIP cabin and a further two guest cabins, one double and one twin.



Platinum Package

Fin stabilization system providing stability underway and at rest.
Flybridge hardtop with retractable centre canopy and aft extending sun canopy.
Air Conditioning Tropical specification with quieter running fans.
One 28kW 50Hz Generator and one 35kW 50Hz Generator.
Second shore power connection.
Hydraulic Stern thruster system.
Fuel polishing system.
Dimmable Lighting switching on all overhead lighting.
Two stainless steel drawer refrigerators with water cooled compressors in Flybridge wet bar.
Additional under counter Galley Refrigeration.
Separate Miele washing machine and Miele tumble dryer.
Teak Flybridge Decking.
Pair of Retractable Cleats for tender on platform.
Additional Stern spring cleats.
Carbon fibre companionway hatch at top of Flybridge stairs.
Sprung mattress for all cabin beds.
Navigation - Flybridge Console:
Two Simrad NSO evo3S 16" Touchscreen Multifunctional Displays and OP50 keypad controller.
Additional 7" touch-screen controlling the Cm8 Sunseeker monitoring.
Simrad Autopilot AP44 system.
Simrad second station RS90s VHF with DSC.
Richie Helmsman HF-743W Flush Mount Magnetic Compass.

Navigation - Main Console

Two Simrad MO24-T 24" Touchscreen Monitors with NSO evo3S Processor and OP50 keypad controller.
Additional 10" touchscreen controlling the Cm8 Sunseeker monitoring
Simrad Halo 6 Pulse Compression Radar 6ft 72nm with velocity track.
Simrad GS25 GPS Antenna.
Simrad Autopilot AP44 system.
Simrad RS90s VHF with DSC. 2.4M whip VHF antenna.
Simrad depth Speed/Depth transducer with water temp B744V and Sonarhub modular.
Simrad structure scan 3D side scan transducers and Sonarhub 3D module.
Simrad Automatic Identification System NAIS500 Class B AIS Transponder system with dedicated 2.4M whip antenna and GPS receiver.
Simrad 110WX Ultrasonic Wind Sensor.
Richie Helmsman HF-743B Flush Mount Magnetic Compass.

Performance AV Package

Saloon - Samsung 55" The Frame UHD 4K QLED TV with Apple TV App and Airplay 2 included with a Ultra HD Blu-ray player. Sonance upgraded front and rear speakers with Sonos Amps and Sonos Subwoofer. Dining area with two additional Sonance speakers with Sonos Amp.
Galley - Samsung 43" UHD 4K TV with Apple TV App and Airplay 2 included. Sonance speakers with Sonos Amp.
Master Stateroom - Samsung 55" The Frame UHD 4K QLED TV with Apple TV App and Airplay 2 included with a Ultra HD Blu-ray player. Sonance upgraded front and rear speakers with Sonos Amps.

Forward VIP Cabin - Samsung 55" UHD 4K TV with Apple TV App and

Airplay 2 included. Sonance upgraded speakers with Sonos Amp.

Port Guest Cabin - Samsung 43" UHD 4K TV with Apple TV App and Airplay

2 included. Sonance upgraded speakers with Sonos Amp.

Starboard Guest Cabin - Samsung 32" HD TV with Apple TV, Sonance

upgraded speakers with Sonos Amp.

Aft Cockpit zone audio with four 8" Sonance Extreme Speakers with Sonos Amp.

Flybridge deck zone audio with six 8" Sonance Extreme Speakers with Sonos Amp.

Fore Deck zone audio with two 6.5" Sonance Extreme Speakers with Sonos Amp.

The zoning audio to be linked via the Sonos App with one tablet supplied for control of the zones.

Other Additional Extras

1 x 100 metres and 1 x 60 metres of 12mm high tensile galvanised short link chain with anchor swivel.

2 x Dining storage tops upgraded to Quartz from Minerva.

Aft Cockpit Covers Package – Cockpit seating.

Aft Cockpit privacy screen – Electrically operated.

All Flybridge Navigation Equipment to be sprayed Black Gloss (note:

Navigation equipment not to be inclusive of warranty due to selection of black paint covering.

Atlas Autoshore 30KVA Shore Supply Voltage Regulator. Ensures galvanic

isolation from shore supply, stabilises the onboard voltage from variations in shore supply voltage. Allows connection to 400V supplies. Upgrades to 125A.

Carpet upgrade throughout boat.

Carpet upgrade throughout lower deck

Compass swinging and adjustment with correction cord.

Crew Mess – 24" HD Television. In the crew mess and each of the cabins a Fusion Apollo head unit for AM/FM radio, USB input, Bluetooth and Apple Airplay connectivity to users device with two Fusion ceiling speakers.

Dining Table top to have Quartz top upgrade from wood.

Discharge from the grey water tank via 1 x Sealand Pump 24Vdc pumping directly over board or via a shore side suction facility through a deck fitting when available.

Each Anchor chain is to be marked every 10 metres - R.Y.B.W.G.

Electric blinds to all lower deck cabins

Electric Blinds to all Main deck saloon, dining area and including Aft Patio

Door curtain

Fabric Upgrades excl Dining Curtain Voiles

Flooring in Saloon to be carpeted.

Flybridge Covers Package - Flybridge seating, sunpad, table and helm seat covers.

Flybridge Wetbar mouldings and doors spray paint finished

Fore Deck Covers Package - Foredeck seating, sunpad and table covers.

Fore Deck seating cushions with optional folding sunbed.

Forward VIP Lobby Port and Starboard panels – Aurora Prism

Freshwater pressure washing of chain with directed outlet.

Grey water from showers and wash basins will drain directly to sump boxes and upgraded 850 litre grey water tank. Grey water from galley services will drain either directly overboard or to grey water tank. Sump boxes pump into the grey water tank.

Hydraulically lifting platform with maximum lift capacity of 1000 kg with Tender maximum weight of 900 kg.

Interior Wood Finish - Combination of Smoked eucalyptus figured high sheen satin with Silver Oak Low build open grain Satin.

LED Navigation lights in lieu of standard.

Lobby Stairwell bulkheads upholstered in Aurora Prism.

Lower Lobby Port and Starboard bulkheads upholstered in Aurora Prism
Main Deck Day Head option in lieu of standard Storage Room.

Marco portable electric transfer pump Oil change system for engines gearboxes and generators with quick coupling connection pipes.

Minotti Owen Dining Chairs

MTU joystick manoeuvring system with dual station control.

Octo Marine Compact Water Softener required for the domestic fresh water system. Fitted in-line from the vessels fresh water shore supply. The outlet will be fitted with valves to fill either direct to tank or to the main system.

One Lewmar 80kg galvanised Delta anchor and One Lewmar 50kg galvanised Delta anchor.

Parasol with offset post with two sockets either side of the Fore Deck.

Port Guest Cabin to be configured with single berths to slide together to create a double berth. Bed coverings are ordered for both double and single set up.

Provide Satellite TV cable preparation only, to include 4 x RG11 Power and Data cables from hardtop to multi switch location above grounds in Saloon and CAT6 cables run there to the Saloon, Master Stateroom, VIP Cabin and Port and Starboard guest cabins. Note: Hardtop domes and decoders not included.

Saloon Outer Headlining panels in Sprayed Lacquer.

Saloon sliding door on the starboard side.

Sanshin Twin Beam remote controlled LED Searchlight HRL2070.

Simrad NSS12 evo3 12" Chartplotter Multifunction touch screen colour display and a third station Simrad RS90S VHF. in the Stern Crew Mess.

Standby fresh water pump Gianneschi Ecoinox 2CE 24Vdc self-priming pump, pressure controlled. Standby pump fitted to enable both pumps to run at the same time if required.

Storage Cage located in the Engine Room.

Sunseeker Cm8 integrated power management 10" Glass touch display, boat monitoring and full access control repeater in the crew mess.

Three polished stainless-steel bar stools.

Twin Lewmar V8 24 Volt DC Windlass. Vertical Gypsy and Capstan drum.

Manual hand wheel brake and Devils Claw chain stopper.

Two Liferaft 10 Man Canister stowed in a stainless-steel frame on the deck.

Underfloor heating for en-suite floors for the Forward En suite, mid cabin En suites and Master En suite.

Underwater lights. Lumishore TIX403 LED x 8 - Dual colour white / Blue.

Four across the stern and two either side.

Upgrade to bed covers and scatter cushions

Upgrade to Flybridge hardtop to include the tilting vane system in lieu of

the soft retractile central canopy

Voile fabric upgrade to curtains in Dining area.

Water Maker Idromar 250 litres per hour (MC5S-250).

Wood flooring in Dining.

X-Tend. Sun-lounger Transforma - The platform locker door folds out electrically exposing a large sun-lounger. Alternatively, the door can fold up forming an aft deck sun-lounger thus extending the cockpit space with the stern glazed safety rails bi-folding to the side.

Full sea and system commissioning

Movement of Yacht to Port of Shipment for export including necessary paperwork

2 - Aft Cockpit



5 - Flybridge



6 - Flybridge



9 - Saloon



10 - Saloon









16 - Master Cabin



17 - Master Cabin





21 - Guest Double



22 - Guest Twin



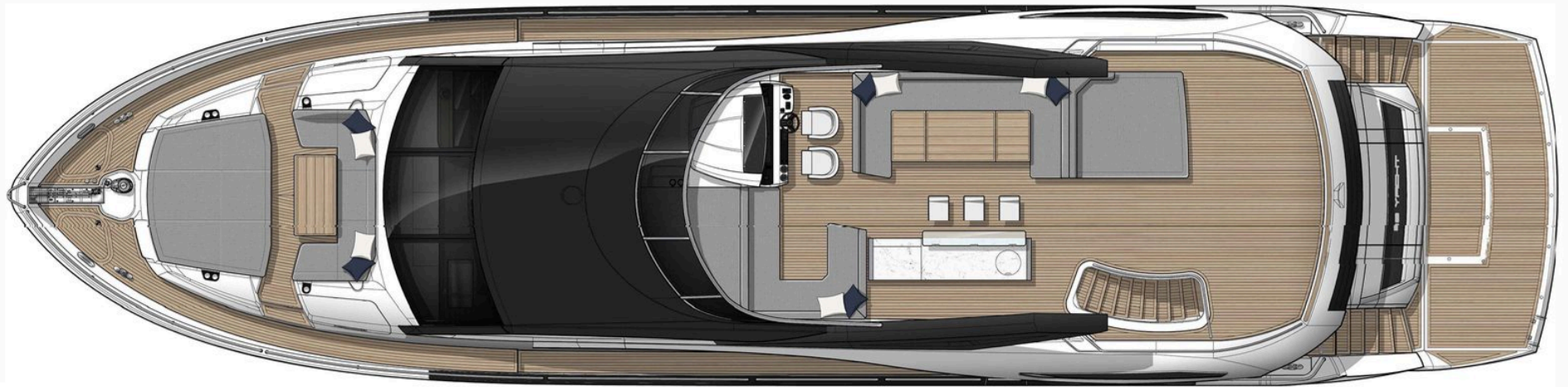



MAIN DECK OPTION
Shown with alternative Salon & Dining arrangement



LOWER DECK OPTION
Shown with optional sofa in Master Stateroom

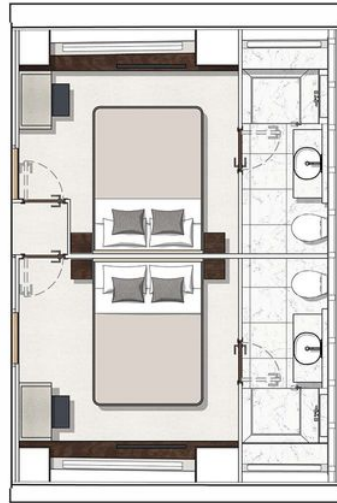

LOWER DECK OPTION
Shown with aft Double Guest Cabins in lieu of
Master Stateroom

