

M/Y ROCKET ONE  
FOR SALE



AQUA MARINE  
GROUP

---

## M/Y ROCKET ONE

The magnificent Majesty 120 is an immaculate superyacht designed for private getaways and effortless entertaining. The powerful 37m Majesty 120 has been built with the owner's preferences in mind, with a strong focus on luxury, performance and comfort.

Aggressive lines and a demanding profile define the Majesty 120, with the signature Majesty Yachts windows lining the hull. Extensive use of glass offers an unparalleled connection to the outdoors with low bulwarks allowing for an ornamental glass railing design.

Amongst the standout features onboard the new Majesty 120 is a Jacuzzi situated on the sun deck. This superyacht boasts 30% larger outdoor entertainment areas compared to any other yacht in its class.

The smart layout onboard the Majesty 120 allows for a beachclub to double as a tender garage, creating a hybrid solution for the guests onboard. The multipurpose ladder that extends from the swim-platform allows for an easier and safer access to the superyacht while moored.





## ASKING PRICE

€13.995.000 EX VAT

## SPECIFICATIONS

Builder:  
Gulf Craft, Majesty Yachts

Length:  
37.00 m (121' 5")

Year Built:  
2022

Draft:  
2.0 m (6' 7")

Flag:  
Marshall Islands

Beam:  
8.00 m (26' 3")

Hull construction:  
Fiber glass

Classification:  
Rina Commercial

Fuel tank:  
21,615 L

Water tank:  
9,874 L

Gross tonnage:  
295 Gt

Stabilizers:  
Electric Fin stabilizers

Engine:  
2 x MTU 16V2000 M96 L  
**(Approx. 300 hours)**

Generator:  
1 x Kohler 125 kw, 50 hz/1 x  
Northern Lights 55 kw, 50 hz

Max speed:  
23 knots

Cruise speed:  
18 knots

Guest cruising:  
12

Guest sleeping:  
12

Number of cabins:  
6

Crew accommodation:  
8 berths

Cabin detail:  
1 Master, 3 Double,  
2 Twin's + 2 pullman bed

---

## TOYS & EQUIPMENT

- 2 x Jet Ski Spark
- 2 x Jet Ski RXP
- 1 x Pirelli tender J50
- 2 x Electric surf Board
- 1 x Electric foil
- 2 x Electric submariner
- 2 x snorkeling equipment
- Water Ski + Wake board

---

## KEY FEATURES

1. Master bedroom on the main deck
2. Jacuzzi on upper deck
3. Three decks that allow impressive living spaces onboard
4. 6 cabin layout for maximum guest comfort

M/Y ROCKET ONE



FLYBRIDGE

MAY ROCKET ONE

AQUA MARINE

## JACUZZI & FLYBRIDGE



M/Y ROCKET ONE

AQUA MARINE  
GROUP

BOW AREA

M/Y ROCKET ONE

AQUA MARINE

BEACH CLUB

M/Y ROCKET ONE

AQUA MARINE



MAIN SALON



M/Y ROCKET ONE

AQUA MARINE  
GROUP

MAIN SALON

M/Y ROCKET ONE

AQUA MARINE  
GROUP

MAIN SALON

M/Y ROCKET ONE

AQUA MARINE  
GROUP

MAIN SALON



M/Y ROCKET ONE

AQUA MARINE  
GROUP

DINING AREA

M/Y ROCKET ONE

AQUA MARINE  
GROUP

UPPER DECK SALON

M/Y ROCKET ONE

AQUA MARINE  
GROUP

UPPER DECK SALON

M/Y ROCKET ONE

AQUA MARINE  
GROUP

UPPER DECK SALON



M/Y ROCKET ONE

AQUA MARINE  
GROUP

MASTER CABIN

M/Y ROCKET ONE

AQUA MARINE  
GROUP

MASTER CABIN

M/Y ROCKET ONE

AQUA MARINE  
GROUP

## MASTER CABIN



M/Y ROCKET ONE

AQUA MARINE  
GROUP

VIP CABIN

M/Y ROCKET ONE

AQUA MARINE  
GROUP

TWIN CABIN

M/Y ROCKET ONE

AQUA MARINE  
GROUP

TWIN CABIN

M/Y ROCKET ONE

AQUA MARINE  
GROUP

WHEELHOUSE



AQUA MARINE  
GROUP

## WHEELHOUSE



M/Y ROCKET ONE

AQUA MARINE  
GROUP



PROFILE



SUNDECK



# LAYOUT

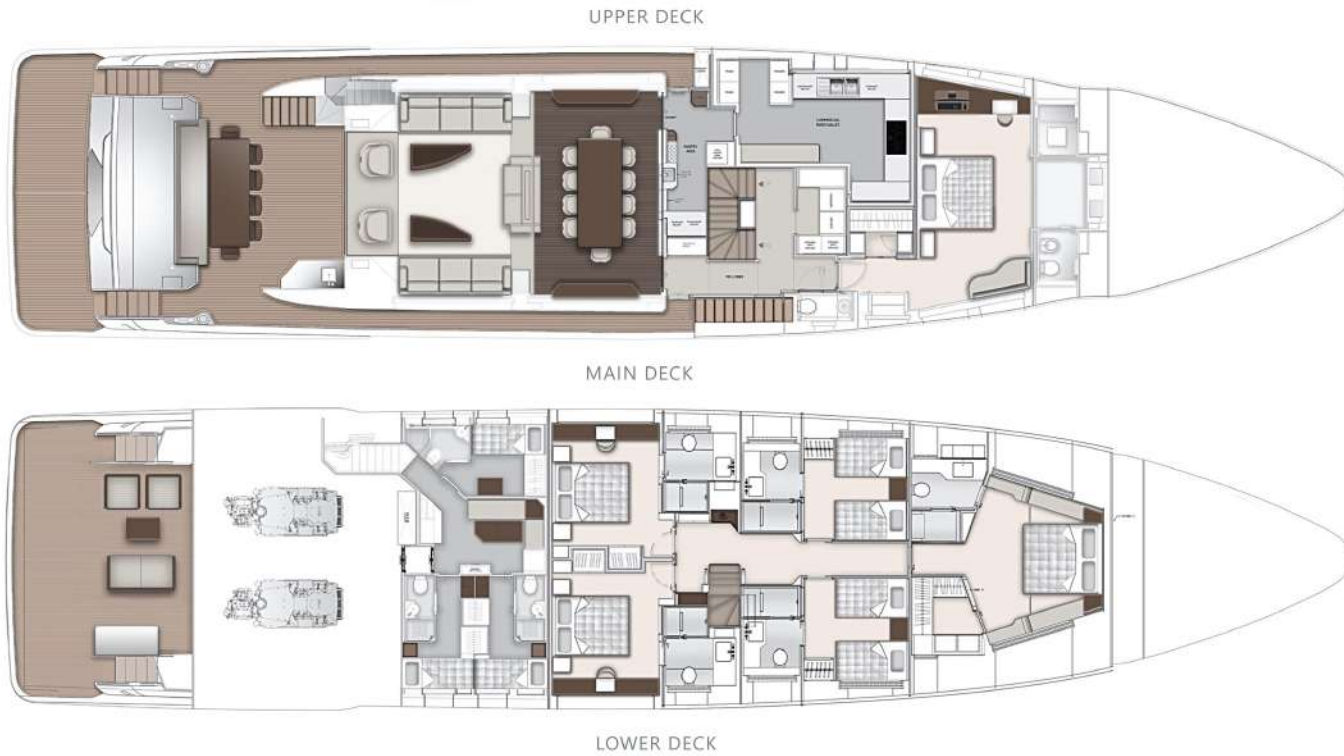

## OPTIONS LIST

- Multifunctional Hydraulic Passerella
- Telescopic Crane 1100Kg Capacity for Dinghy Launching System
- Jetski Stand - 2 Nos
- Upgrade to Commercial-professional Galey (Aluminox) instead of Standard Appliances
- Aluminum Teak Swimming Ladder instead of Standard SS Ladder
- AFT Hawser pipe height extension - 02 Pcs
- Storage in the saloon sofa lounge and sky lounge
- Privacy Screen - Vertical sun curtain in cockpit (Motorised Curtain with Blackout) - Sun way
- Twin Guest Cabin bed convertible to double
- Mooring Bits add Stopper Ring & Bollard FRP base to be raised by 1"
- Fresh water inlet direct to fill the tank (Inlet to be provided both from port & stbd sides)
- On each bedrooms - Power outlets and switch to control all lights of the area on both side of the beds
- Anchor Chain Area to build storage
- All exterior lockers require grill and drain
- Clips for cover in stainless steel at Wheelhouse area instead of Standard Prefix Buttons
- Idromar Water Maker 500ltr/hrs instead of std HP 540ltr/hrs (Variation)
- Water Softener and UV Lamp (Brannstorm/silver Ion Sterlizer + Flowmeter + Solenoidvalve / S168)
- All Outside Fabric covers (Waterproof) instead of std
- Safes in VIP Cabins (Zener:smartbox laptop S) - 03 Pcs (Additional)
- Outside Teak Furniture
- Wing Stations (Port&Stbd) - Real side Helm Station which can be plugged on both sides of the boat
- Floor Switch for electric door between Galley & Guest Area
- Additional Dishwasher (Electrolux) In the pantry area
- Extra Refrigeration (Vitrifrigo) at Sky lounge 1pc
- GSM Range Extension outdoor Antenna (ANT-100-LTE4-G0) 1PC
- Satellite Internet Antenna INTELLIAN V5-85K-U2TC Ka Band (VSAT Antenna) + Voip phone GXP-1625 1Pc
- Additional Bed in Captain's Cabin
- 2 extra Navigational 19" LCD Multi Display to be added in Helm
- Extra Ice Maker (Vitrifrio- 230VAC) at Main deck pantry&Flybridge 1pc
- "Additional Material Equipment On wheelhouse"
  - Helm Seats on either side of the bridge
  - Flip down chart table AFT bulkhead + 2X chart lights + 2x red curtesy lights
  - 2x chart storage drawers to add to the step below the sofa unit
  - Flip up table on either side of the bridge
  - Work top on both sides to use acrylic sheet on top of leather finish
  - Replace the sTBD side DB panel to below the bridge and convert the existing low cabinet into storage for classifieds.

---

## OPTIONS LIST

- All Exterior Storage locker door stoppers instead of Standard door stoppers
- Port&stbd life ring to be recessed in the structure
- Gunnel area port side entrance to engine room outlet and light switch
- Gunnel area port side light and socket
- All filters must have ball valves on inlet and outlet pipes
- Aft Crew area layout modification
- Owner Cabin-Computer desk Instead
- MD aft Cockpit table Extended type
- New layout for the panoramic saloon
- New armchair selection for main salon
- All Steptreads to be finished in W
- Ld twin guest cabin ceiling
- LD double guest cabin headboard wall finitions
- Handrail design to have end caps
- Wallpaper to be changed to veneer
- New ceiling design
- Main dining low counters veneer
- Main dining fwd feature wall
- Main saloon sofa to have 75mm Skirt
- Pullman bed at port and st side
- TV on wall in main salon
- Ceiling lights
- Sundeck aft sunbeds
- Main deck day head window frame
- Intellian satellite TVRO S80HD ins
- Beach club Layout with counter + icemaker, fridge, speakers
- Sundeack lounges Terry cloth
- Upper deck dining table
- Full set of bedding
- Tow pro system
- Yacht name
- Cradles for jetski 2pcs
- Bench above the port side gear box
- Suit hooks in bathrooms x 20 units
- Add shelves in captain wardrobe
- Additional shelves in all location
- Additional wash machine/dryer
- Ironing table foldable laundry area
- Shelves + plexiglass pantry area
- Add dishwasher in crew mess
- Towels support for bathrooms
- Provision for shore power converter
- Crane 770k lifting cap.







AQUA MARINE  
GROUP